

# Linha: Plugues e Tomadas Blindadas Brasikon® Newkon® Shock Tite® Surelock®

## Tabela para Baixa Tensão

### 16A - 32A - 63A - 125A - 200A

Tensão de Utilização	Frequência Hz	Posição Horária					
		2P + T 16 e 32A 63 e 125A		3P + T 16 e 32A 63 e 125A		3P + N + T 16 e 32A 63 e 125A	
100 a 130	50 e 60	4	4	4	4	4	4
200 a 250	50 e 60	6	6	9	9	9	9
380 a 440	50 e 60	9	9	6	6	6	6
250 / 440	60					11	11
440	60			11	11		
500	50 e 60	7	7	7	7	7	7
600 a 750	50 e 60	5	5	5	5	5	5
Mais de 50	100 a 300	10	10	10	10	10	10
Mais de 50	de 300 a 500	2	2	2	2	2	2
De 50 a 250	Corrente Contínua	3	3				
Mais de 250	Corrente Contínua	8	8				

Exemplo:

## Tabela para Baixíssima Tensão 16A e 32A

Número de Pólos	Frequência Hz	Tensão V	Pino Terra em Horas	Cor
	50 e 60	20 a 25	-	Lilás
	50 e 60	40 a 50	12	Branco
2 e 3	de 100 a 200	até 50	4	Verde
	300	até 50	2	Verde
	400	até 50	3	Verde
	mais de 400 até 500	até 50	11	Verde
2	c.c.	até 50	10	Branco

## Identificar Posição Terra pela Tomada (fêmea)

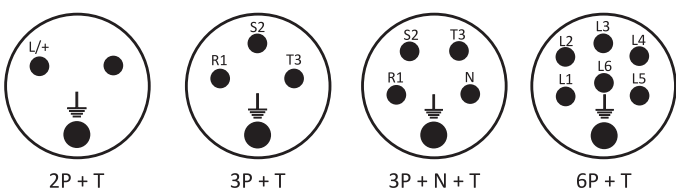

## DISPOSITIVO ADICIONAL DE SEGURANÇA: Brasikon® Newkon® Shock Tite® Surelock®

As conexões 63, 125 e 200A podem ser fornecidas com contato piloto (opcional) na parte central. Este contato piloto fecha depois dos outros.

Ao retirar o plugue, este contato abre-se antes dos outros, evitando assim os perigos do arco elétrico. Para solicitar o contato piloto acrescentar a letra "P" após a referência do produto.

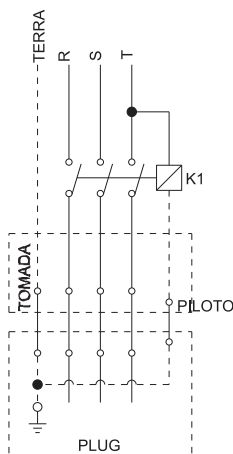

## Exemplo de circuito de comando

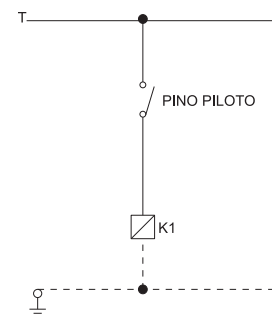

Obs:1- O pino piloto é o último a ser conectado e o 1º a ser desconectado.  
2- A In do contator deve ser ≥ a da tomada.

Tensão	Cor
20 e 25V	Violeta
40 a 50V	Branca
110 a 130V	Amarela
220 a 240V	Azul
380 a 440V	Vermelha
500 a 750V	Preta
Acima de 60 a 500 Hz	Verde

# Linha: Plugues e Tomadas Blindadas Brasikon<sup>®</sup>



## Características Gerais

### Matérias Primas:

Partes plásticas: Termo-plástico auto-extinguível (C.S.A. C22.2 nº6 e UL 94HB-Mil spec 22096).  
Vedações e guarnições: SBR.  
Terminais: Latão maciço.

### Temperatura Operação:

0 / 120°C trabalho contínuo.  
200°C (30 minutos).

### Construção:

Conforme normas NBR IEC 60309-1, IEC 60309-2, DIN 49462, DIN 49463, CEE 17-BS4343 e VDE 0623.

### Voltagem máxima de trabalho:

690 Volts RMS - Conforme NBR IEC 60309-1

### Identificação dos Terminais:

Conforme U.L., CSA e NBR IEC 60309

Fases	Neutro	Terra
1 - 2 - 3 R - S - T X - Y - Z L	N W	

### Resistência ao Arco:

Conforme C.S.A. C22.2-182-1 (1990)  
Altamente isolante (até 750V - 500Hz)

### Rigidez Dielétrica: NBR IEC 60309-1

Tens. Nom.	Tens. Ensaio
Até 50V	500V
Até 415V	2.000V
Até 500V	2.500V
Acima de 500V	3.000V



### Resistência ao Impacto:

Conforme C.S.A. C22.2 nº 182-1 parágrafos 7.4.2 e 7.4.4

### Resistência à Abrasão:

Conforme C.S.A. C22.2 nº 182-1 parágrafos 7.4.3 e 7.4.4

### Estanqueidade:

Conforme norma NBR IEC 60529

### Proteção Cabos:

Conforme C.S.A. C. nº 182-1 parágrafos 7.3

### Tipo de Cabos:

Conforme U.L.62 e C.S.A.C22.2 nº 49

### Resistências à Corrosão: (Partes Plásticas)

Salt Spray, Álcool, Óleo, Solventes, Lubrificantes, Graxas, Meios ácidos, Alcalinas e Outros Agentes Químicos.

Obs.: Dimensões e Desenhos no final da linha

Contatos Niquelados acrescer NQ após o código.

# Linha: Plugues e Tomadas Blindadas Brasikon

Produto	Amp.	Pólos	24V	110 / 130V	220 / 240V	380 / 440V	600V	Até 500Hz												
<b>Plugue</b>  IP 44 ▲ Ligação nos contatos (mm <sup>2</sup> ) <table border="1"> <tr> <td>Amp.</td> <td>16A</td> <td>32A</td> </tr> <tr> <td>Mín.</td> <td>2,5</td> <td>4,0</td> </tr> <tr> <td>Máx.</td> <td>4,0</td> <td>6,0</td> </tr> </table>	Amp.	16A	32A	Mín.	2,5	4,0	Máx.	4,0	6,0	16	3	S-3072	S-3074	S-3076	S-3079	S-3075	S-3070			
	Amp.	16A	32A																	
	Mín.	2,5	4,0																	
	Máx.	4,0	6,0																	
	16	4	S-4072	S-4074	S-4079	S-4076	S-4075	S-4070												
	16	5	S-5072	S-5074	S-5079	S-5076	S-5075	S-5070												
	32	3	S-3272	S-3274	S-3276	S-3279	S-3275	S-3270												
	32	4	S-4272	S-4274	S-4279	S-4276	S-4275	S-4270												
	32	5	S-5272	S-5274	S-5279	S-5276	S-5275	S-5270												
	16	7				S-007-6														
32	7				S-027-6															
<b>Plugue Negativo (fêmea) IP 44</b> ▲  Ligação nos contatos (mm <sup>2</sup> ) <table border="1"> <tr> <td>Amp.</td> <td>16A</td> <td>32A</td> </tr> <tr> <td>Mín.</td> <td>2,5</td> <td>4,0</td> </tr> <tr> <td>Máx.</td> <td>4,0</td> <td>6,0</td> </tr> </table>	Amp.	16A	32A	Mín.	2,5	4,0	Máx.	4,0	6,0	16	3	SN-3072	SN-3074	SN-3076	SN-3079	SN-3075	SN-3070			
	Amp.	16A	32A																	
	Mín.	2,5	4,0																	
	Máx.	4,0	6,0																	
	16	4	SN-4072	SN-4074	SN-4079	SN-4076	SN-4075	SN-4070												
	16	5	SN-5072	SN-5074	SN-5079	SN-5076	SN-5075	SN-5070												
	32	3	SN-3272	SN-3274	SN-3276	SN-3279	SN-3275	SN-3270												
32	4	SN-4272	SN-4274	SN-4279	SN-4276	SN-4275	SN-4270													
32	5	SN-5272	SN-5274	SN-5279	SN-5276	SN-5275	SN-5270													
<b>Plugue</b>  IP 67 ▲▲ Ligação nos contatos (mm <sup>2</sup> ) <table border="1"> <tr> <td>Amp.</td> <td>63A</td> <td>125A</td> <td>200A</td> </tr> <tr> <td>Mín.</td> <td>10,0</td> <td>35,0</td> <td></td> </tr> <tr> <td>Máx.</td> <td>16,0</td> <td>70,0</td> <td>95,0</td> </tr> </table>	Amp.	63A	125A	200A	Mín.	10,0	35,0		Máx.	16,0	70,0	95,0	63	3	S-3572	S-3574	S-3576	S-3579	S-3575	S-3570
	Amp.	63A	125A	200A																
	Mín.	10,0	35,0																	
	Máx.	16,0	70,0	95,0																
	63	4	S-4572	S-4574	S-4579	S-4576	S-4575	S-4570												
	63	5	S-5572	S-5574	S-5579	S-5576	S-5575	S-5570												
	125	3	S-3672	S-3674	S-3676	S-3679	S-3675	S-3670												
	125	4	S-4672	S-4674	S-4679	S-4676	S-4675	S-4670												
	125	5	S-5672	S-5674	S-5679	S-5676	S-5675	S-5670												
	200	3		S-3874W	S-3876W	S-3879W	S-3875W													
200	4		S-4874W	S-4876W	S-4879W	S-4875W														
<b>Plugue Negativo (fêmea) IP 67</b> ▲▲  Ligação nos contatos (mm <sup>2</sup> ) <table border="1"> <tr> <td>Amp.</td> <td>63A</td> <td>125A</td> <td>200A</td> </tr> <tr> <td>Mín.</td> <td>10,0</td> <td>35,0</td> <td>-</td> </tr> <tr> <td>Máx.</td> <td>16,0</td> <td>70,0</td> <td>95,0</td> </tr> </table>	Amp.	63A	125A	200A	Mín.	10,0	35,0	-	Máx.	16,0	70,0	95,0	63	3	SN-3572	SN-3574	SN-3576	SN-3579	SN-3575	SN-3570
	Amp.	63A	125A	200A																
	Mín.	10,0	35,0	-																
	Máx.	16,0	70,0	95,0																
	63	4	SN-4572	SN-4574	SN-4579	SN-4576	SN-4575	SN-4570												
	63	5	SN-5572	SN-5574	SN-5579	SN-5576	SN-5575	SN-5570												
	125	3	SN-3672	SN-3674	SN-3676	SN-3679	SN-3675	SN-3670												
	125	4	SN-4672	SN-4674	SN-4679	SN-4676	SN-4675	SN-4670												
	125	5	SN-5672	SN-5674	SN-5679	SN-5676	SN-5675	SN-5670												
	200	3		SN-3874/W	SN-3876/W	SN-3879/W	SN-3875/W													
200	5		SN-4874/W	SN-4876/W	SN-4879/W	SN-4875/W														
<b>Plugue 90º</b>  IP 44 ▲ Ligação nos contatos (mm <sup>2</sup> ) <table border="1"> <tr> <td>Amp.</td> <td>16A</td> <td>32A</td> </tr> <tr> <td>Mín.</td> <td>2,5</td> <td>4,0</td> </tr> <tr> <td>Máx.</td> <td>4,0</td> <td>6,0</td> </tr> </table>	Amp.	16A	32A	Mín.	2,5	4,0	Máx.	4,0	6,0	16	3		S-11630	S-11633	S-11638					
	Amp.	16A	32A																	
	Mín.	2,5	4,0																	
	Máx.	4,0	6,0																	
	16	4		S-11631	S-11634	S-11636	S-116367	S-116361												
	16	5		S-11632	S-11635	S-11637	S-116377													
	32	3		S-13230	S-13233	S-13238														
	32	4		S-13231	S-13234	S-13236	S-132367	S-132361												
32	5		S-13232	S-13235	S-13237	S-132377														
<b>Tomada de sobrepôr</b>  IP 44 ▲ Opção rosca GAS(*) Ligação nos contatos (mm <sup>2</sup> ) <table border="1"> <tr> <td>Amp.</td> <td>16A</td> <td>32A</td> </tr> <tr> <td>Mín.</td> <td>2,5</td> <td>4,0</td> </tr> <tr> <td>Máx.</td> <td>4,0</td> <td>6,0</td> </tr> </table>	Amp.	16A	32A	Mín.	2,5	4,0	Máx.	4,0	6,0	16	3	S-3002	S-3004	S-3006	S-3009	S-3005	S-3000			
	Amp.	16A	32A																	
	Mín.	2,5	4,0																	
	Máx.	4,0	6,0																	
	16	4	S-4002	S-4004	S-4009	S-4006	S-4005	S-4000												
	16	5	S-5002	S-5004	S-5009	S-5006	S-5005	S-5000												
	32	3	S-3202	S-3204	S-3206	S-3209	S-3205	S-3200												
	32	4	S-4202	S-4204	S-4209	S-4206	S-4205	S-4200												
	32	5	S-5202	S-5204	S-5209	S-5206	S-5205	S-5200												
	16	7				S-100-6														
32	7				S-127-6															



Obs.: Para Contatos Niquelados acrescentar NQ após o código  
 (\*) para rosca Gas verificar tabela de adaptadores página 67

# Linha: Plugues e Tomadas Blindadas Brasikon®

Produto	Amp.	Pólos	24V	110 / 130V	220 / 240V	380 / 440V	600V	Até 500Hz
Tomada de sobrepor negativa (macho)  IP 44▲ Opção rosca GAS(*) Ligação nos contatos (mm <sup>2</sup> )	16	3	SN-3002	SN-3004	SN-3006	SN-3009	SN-3005	SN-3000
	16	4	SN-4002	SN-4004	SN-4009	SN-4006	SN-4005	SN-4000
	16	5	SN-5002	SN-5004	SN-5009	SN-5006	SN-5005	SN-5000
	32	3	SN-3202	SN-3204	SN-3206	SN-3209	SN-3205	SN-3200
	32	4	SN-4202	SN-4204	SN-4209	SN-4206	SN-4205	SN-4200
	32	5	SN-5202	SN-5204	SN-5209	SN-5206	SN-5205	SN-5200
Tomada de sobrepor  IP 67▲▲ Opção rosca GAS(*) Ligação nos contatos (mm <sup>2</sup> )	63	3	S-3502	S-3504	S-3506	S-3509	S-3505	S-3500
	63	4	S-4502	S-4504	S-4509	S-4506	S-4505	S-4500
	63	5	S-5502	S-5504	S-5509	S-5506	S-5505	S-5500
Tomada de sobrepor negativa (macho)  IP 67▲▲ Opção rosca GAS(*) Ligação nos contatos (mm <sup>2</sup> )	63	3	SN-3502	SN-3504	SN-3506	SN-3509	SN-3505	SN-3500
	63	4	SN-4502	SN-4504	SN-4509	SN-4506	SN-4505	SN-4500
	63	5	SN-5502	SN-5504	SN-5509	SN-5506	SN-5505	SN-5500
Tomada de sobrepor  IP 67▲▲ Opção rosca GAS(*)+ Ligação nos contatos (mm) <sup>2</sup>	125	3	S-3602	S-3604	S-3606	S-3609	S-3605	S-3600
	125	4	S-4602	S-4604	S-4609	S-4606	S-4605	S-4600
	125	5	S-5602	S-5604	S-5609	S-5606	S-5605	S-5600
	200	3		S-3804	S-3806	S-3809	S-3805	
	200	4		S-4804	S-4809	S-4806	S-4805	
Tomada de sobrepor negativa (macho)  IP 67▲▲ Opção rosca GAS(*) Ligação nos contatos (mm) <sup>2</sup>	125	3	SN-3602	SN-3604	SN-3606	SN-3609	SN-3605	SN-3600
	125	4	SN-4602	SN-4604	SN-4609	SN-4606	SN-4605	SN-4600
	125	5	SN-5602	SN-5604	SN-5609	SN-5606	SN-5605	SN-5600
	200	3		SN-3804	SN-3806	SN-3809	SN-3805	
	200	4		SN-4804	SN-4809	SN-4806	SN-4805	
Tomada de embutir  IP 44▲ Ligação nos contatos (mm) <sup>2</sup>	16	3	S-3042	S-3044	S-3046	S-3049	S-3045	S-3040
	16	4	S-4042	S-4044	S-4049	S-4046	S-4045	S-4040
	16	5	S-5042	S-5044	S-5049	S-5046	S-5045	S-5040
	32	3	S-3242	S-3244	S-3246	S-3249	S-3245	S-3240
	32	4	S-4242	S-4244	S-4249	S-4246	S-4245	S-4240
	32	5	S-5242	S-5244	S-5249	S-5246	S-5245	S-5240
	16	7				S-104-6		
	32	7				S-124-6		





Obs.: Para Contatos Niquelados acrescentar NQ após o código  
 (\*) para rosca Gas verificar adaptadores página 67

# Linha: Plugues e Tomadas Blindadas Brasikon®

Produto		Amp.	Pólos	24V	110 / 130V	220 / 240V	380 / 440V	600V	Até 500Hz											
 <p>Tomada de embutir negativa (macho)</p> <p>IP 44 ⚠</p> <p>Ligação nos contatos (mm<sup>2</sup>)</p> <table border="1"> <tr> <td>Amp.</td> <td>16A</td> <td>32A</td> </tr> <tr> <td>Mín.</td> <td>2,5</td> <td>4,0</td> </tr> <tr> <td>Máx.</td> <td>4,0</td> <td>6,0</td> </tr> </table>	Amp.	16A	32A	Mín.	2,5	4,0	Máx.	4,0	6,0	16	3	SN-3042	SN-3044	SN-3046	SN-3049	SN-3045	SN-3040			
	Amp.	16A	32A																	
	Mín.	2,5	4,0																	
	Máx.	4,0	6,0																	
	16	4	SN-4042	SN-4044	SN-4049	SN-4046	SN-4045	SN-4040												
	16	5	SN-5042	SN-5044	SN-5049	SN-5046	SN-5045	SN-5040												
	32	3	SN-3242	SN-3244	SN-3246	SN-3249	SN-3245	SN-3240												
	32	4	SN-4242	SN-4244	SN-4249	SN-4246	SN-4245	SN-4240												
	32	5	SN-5242	SN-5244	SN-5249	SN-5246	SN-5245	SN-5240												
	 <p>Tomada de embutir negativa (macho)</p> <p>IP 67 ⚡</p> <p>Ligação nos contatos (mm<sup>2</sup>)</p> <table border="1"> <tr> <td>Amp.</td> <td>63A</td> <td>125A</td> </tr> <tr> <td>Mín.</td> <td>10,0</td> <td>35,0</td> </tr> <tr> <td>Máx.</td> <td>16,0</td> <td>70,0</td> </tr> </table>	Amp.	63A	125A	Mín.	10,0	35,0	Máx.	16,0	70,0	63	3	S-3542	S-3544	S-3546	S-3549	S-3545	S-3540		
Amp.		63A	125A																	
Mín.		10,0	35,0																	
Máx.		16,0	70,0																	
63		4	S-4542	S-4544	S-4549	S-4546	S-4545	S-4540												
63		5	S-5542	S-5544	S-5549	S-5546	S-5545	S-5540												
125		3	S-3642	S-3644	S-3646	S-3649	S-3645	S-3640												
125		4	S-4642	S-4644	S-4649	S-4646	S-4645	S-4640												
125		5	S-5642	S-5644	S-5649	S-5646	S-5645	S-5640												
200		3	S-3844	S-3846	S-3849	S-3845														
200	4	S-4844	S-4849	S-4846	S-4845															
 <p>Tomada de embutir negativa (macho)</p> <p>IP 67 ⚡</p> <p>Ligação nos contatos (mm<sup>2</sup>)</p> <table border="1"> <tr> <td>Amp.</td> <td>63A</td> <td>125A</td> <td>200A</td> </tr> <tr> <td>Mín.</td> <td>10,0</td> <td>35,0</td> <td>-</td> </tr> <tr> <td>Máx.</td> <td>16,0</td> <td>70,0</td> <td>95,0</td> </tr> </table>	Amp.	63A	125A	200A	Mín.	10,0	35,0	-	Máx.	16,0	70,0	95,0	63	3	SN-3542	SN-3544	SN-3546	SN-3549	SN-3545	SN-3540
	Amp.	63A	125A	200A																
	Mín.	10,0	35,0	-																
	Máx.	16,0	70,0	95,0																
	63	4	SN-4542	SN-4544	SN-4549	SN-4546	SN-4545	SN-4540												
	63	5	SN-5542	SN-5544	SN-5549	SN-5546	SN-5545	SN-5540												
	125	3	SN-3642	SN-3644	SN-3646	SN-3649	SN-3645	SN-3640												
	125	4	SN-4642	SN-4644	SN-4649	SN-4646	SN-4645	SN-4640												
	125	5	SN-5642	SN-5644	SN-5649	SN-5646	SN-5645	SN-5640												
	200	3	SN-3844	SN-3846	SN-3849	SN-3845														
200	4	SN-4844	SN-4849	SN-4846	SN-4845															
 <p>Acoplamento (extensão)</p> <p>IP 44 ⚠</p> <p>Ligação nos contatos (mm<sup>2</sup>)</p> <table border="1"> <tr> <td>Amp.</td> <td>16A</td> <td>32A</td> </tr> <tr> <td>Mín.</td> <td>2,5</td> <td>4,0</td> </tr> <tr> <td>Máx.</td> <td>4,0</td> <td>6,0</td> </tr> </table>	Amp.	16A	32A	Mín.	2,5	4,0	Máx.	4,0	6,0	16	3	S-3052	S-3054	S-3056	S-3059	S-3055	S-3050			
	Amp.	16A	32A																	
	Mín.	2,5	4,0																	
	Máx.	4,0	6,0																	
	16	4	S-4052	S-4054	S-4059	S-4056	S-4055	S-4050												
	16	5	S-5052	S-5054	S-5059	S-5056	S-5055	S-5050												
	32	3	S-3252	S-3254	S-3259	S-3259	S-3255	S-3250												
	32	4	S-4252	S-4254	S-4259	S-4256	S-4255	S-4250												
	32	5	S-5252	S-5254	S-5259	S-5256	S-5255	S-5250												
	16	7				S-105-6														
32	7				S-125-6															
 <p>Acoplamento (extensão)</p> <p>IP 67 ⚡</p> <p>Ligação nos contatos (mm<sup>2</sup>)</p> <table border="1"> <tr> <td>Amp.</td> <td>63A</td> <td>125A</td> <td>125A</td> </tr> <tr> <td>Mín.</td> <td>10,0</td> <td>35,0</td> <td>-</td> </tr> <tr> <td>Máx.</td> <td>16,0</td> <td>70,0</td> <td>95,0</td> </tr> </table>	Amp.	63A	125A	125A	Mín.	10,0	35,0	-	Máx.	16,0	70,0	95,0	63	3	S-3552	S-3554	S-3556	S-3559	S-3555	S-3550
	Amp.	63A	125A	125A																
	Mín.	10,0	35,0	-																
	Máx.	16,0	70,0	95,0																
	63	4	S-4552	S-4554	S-4559	S-4556	S-4555	S-4550												
	63	5	S-5552	S-5554	S-5559	S-5556	S-5555	S-5550												
	125	3	S-3652	S-3654	S-3656	S-3659	S-3655	S-3650												
	125	4	S-4652	S-4654	S-4659	S-4656	S-4655	S-4650												
	125	5	S-5652	S-5654	S-5659	S-5656	S-5655	S-5650												
	200	3		S-3854W	S-3859W	S-3856W	S-3855W													
200	4		S-4854W	S-4859W	S-4856W	S-4855W														

Obs.: Para Contatos Niquelados acrescentar NQ após o código.

# Linha: Plugues e Tomadas Blindadas Brasikon®

Produto	Amp.	Pólos	24V	110 / 130V	220 / 240V	380 / 440V	600V	Até 500Hz									
<b>Extensão Brasikon</b> Tipo: 2BC  Extensão cabeada com Plugue (5m de Cabo), mais 2 Tomadas Ligação nos contatos (mm²) <table border="1"> <tr> <td>Amp.</td> <td>16A</td> <td>32A</td> </tr> <tr> <td>Mín.</td> <td>2,5</td> <td>4,0</td> </tr> <tr> <td>Máx.</td> <td>4,0</td> <td>6,0</td> </tr> </table>	Amp.	16A	32A	Mín.	2,5	4,0	Máx.	4,0	6,0	16	3	S-1722	S-1724	S-1726	S-1729	S-1725	S-1720
	Amp.	16A	32A														
	Mín.	2,5	4,0														
	Máx.	4,0	6,0														
	16	4	S-1822	S-1824	S-1829	S-1826	S-1825	S-1820									
	16	5	S-1922	S-1924	S-1929	S-1926	S-1925	S-1920									
32	3	S-2722	S-2724	S-2726	S-2729	S-2725	S-2720										
32	4	S-2822	S-2824	S-2829	S-2826	S-2825	S-2820										
<b>Módulo Tomada Brasikon</b> Características:  01 Tomada Brasikon Ligação nos contatos (mm²) <table border="1"> <tr> <td>Amp.</td> <td>16A</td> <td>32A</td> </tr> <tr> <td>Mín.</td> <td>2,5</td> <td>4,0</td> </tr> <tr> <td>Máx.</td> <td>4,0</td> <td>6,0</td> </tr> </table> Dimensões externas: 114 x 114 x 91,5mm Opção rosca GAS (Ver tabela abaixo)	Amp.	16A	32A	Mín.	2,5	4,0	Máx.	4,0	6,0	16	3	SOB CONSULTA	SP-3004	SP-3006	SP-3009	SP-3005	SOB CONSULTA
	Amp.	16A	32A														
	Mín.	2,5	4,0														
	Máx.	4,0	6,0														
	16	4	SP-4004	SP-4009	SP-4006	SP-4005											
	16	5	SP-5004	SP-5009	SP-5006	SP-5005											
32	3	SP-3204	SP-3206	SP-3209	SP-3205												
32	4	SP-4204	SP-4209	SP-4206	SP-4205												
32	5	SP-5204	SP-5209	SP-5206	SP-5205												
<b>Tampa de Proteção para Plugs</b>  À prova d'água	63	3/4/5	S-66350														
	125	3/4/5	S-67350														
<b>Plugue e Acoplamento para Baixíssima Tensão - IP44</b> Características: Tensão 42Vca 3 Pólos (12h) 16A Cor Branca	<b>Plugue</b>  S-083		<b>Acoplamento</b>  S-283														

## Tabela de Adaptadores de Rosca PG/GAS

Esta tabela serve para os seguintes produtos:

Tomadas Blindadas Brasikon®

Tomadas Blindadas Shock-Tite®

Tomadas Bloqueio Mecânico Surelock®

Tomadas Blindadas Newkon®



De Rosca	Para: Rosca	
PG 11,0	BSP 3/8	S-0160
PG 13,5	NPT 1/2	S-0046
PG 16,0	NPT 1/2	S-0047
	NPT 3/4	S-0048
PG 21,0	NPT 3/4	S-0049
	BSP 3/4	S-0149
	BSP 1	S-042
PG 29,0	BSP 1 1/2	S-0029
	NPT 1 1/2	S-0030
	NPT 1	S-0051
BSP 1/2	PG 16	S-0156
	NPT 1/2	S-0052

De Rosca	Para: Rosca	
BSP 3/4	PG 21	S-0058
	BSP 3/4	S-0152
	NPT 3/4	S-0053
BSP 3/8	PG 11	S-070112
BSP 1	NPT 1	S-0054
	PG 29	S-0145
	BSP 3/4	S-0144
BSP 1 1/4	NPT 1 1/4	S-0055

# Linha: Plugues e Tomadas Blindadas Brasikon

## Dimensões e Desenhos Técnicos

### Plugue e Plugue Negativo (fêmea) - 16A até 200A

Corrente	16A				32A				63A			125A			200A		
	3	4	5	7	3	4	5	7	3	4	5	3	4	5	3	4	5
A	43,2	49,8	57,0	57,0	57,0	57,0	62,5	62,5	110,5	110,5	110,5	124,5	124,5	124,5	124,5	124,5	124,5
B	112,0	112,0	136,0	136,0	136,0	136,0	161,3	161,3	250,5	250,5	250,5	320,6	320,6	320,6	326,0	326,0	326,0
C	75,0	75,0	99,3	99,3	91,6	91,6	116,2	116,2	204,0	204,0	204,0	263,1	263,1	263,1	263,1	263,1	263,1
ROSCA BSP	-	-	-	-	-	-	-	-	1 1/2"	1 1/2"	1 1/2"	2 1/4"	2 1/4"	2 1/4"	2 1/4"	2 1/4"	2 1/4"
Ø Cabo	Mín.	8,0	8,0	13,0	13,0	15,0	15,0	13,0	13,0	32,0	32,0	32,0	37,0	37,0	37,0	37,0	37,0
	Máx.	13,0	13,0	15,0	15,0	22,0	22,0	15,0	15,0	38,0	38,0	38,0	44,0	44,0	44,0	44,0	44,0

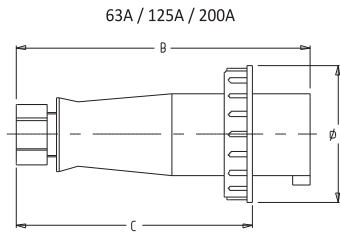
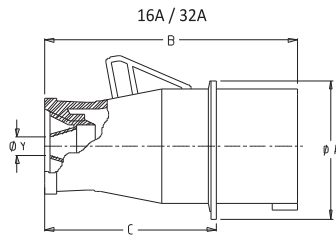

### Plugue 90°

Corrente	16A			32A		
	3	4	5	3	4	5
A	70,0	77,0	88,0	90,0	90,0	100,0
B	109,0	113,0	117,0	135,0	135,0	135,0
Ø Cabo	Mín.	8,0	8,0	13,0	15,0	13,0
	Máx.	13,0	13,0	15,0	22,0	15,0

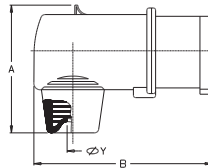

### Tomada de Sobrepor e Tomada de Sobrepor Negativa (macho) 16A até 200A

Corrente	16A				32A				63A			125A			200A		
	3	4	5	7	3	4	5	7	3	4	5	3	4	5	3	4	5
A	81,1	81,1	79,5	79,5	79,5	79,5	90,4	82,0	121,0	121,0	121,0	160,0	160,0	160,0	160,0	160,0	160,0
B	117,1	117,1	146,8	146,8	146,8	146,8	154,8	152,0	252,0	252,0	252,0	344,0	344,0	344,0	344,0	344,0	344,0
C	88,6	88,6	105,0	105,0	105,0	105,0	113,5	105,0	125,0	125,0	125,0	192,0	192,0	192,0	192,0	192,0	192,0
D	70,0	70,0	48,4	48,4	48,4	48,4	50,0	60,0	85,0	85,0	85,0	139,0	139,0	139,0	139,0	139,0	139,0
E	-	-	-	-	64,0	64,0	68,0	47,5	105,0	105,0	105,0	240,0	240,0	240,0	240,0	240,0	240,0
F	-	-	-	-	-	-	-	-	122,0	122,0	122,0	-	-	-	-	-	-
Rosca PG	16	16	21	21	21,0	21,0	21,0	21,0	29	29	29	-	-	-	-	-	-
Rosca BSP	-	-	-	-	-	-	-	-	-	-	-	1 1/2"	1 1/2"	1 1/2"	1 1/2"	1 1/2"	1 1/2"
Ø Cabo	Mín.	10,0	10,0	13,0	13,0	13,0	13,0	13,0	18,0	18,0	18,0	32,0	32,0	32,0	32,0	32,0	32,0
	Máx.	14,0	14,0	18,0	18,0	18,0	18,0	18,0	25,0	25,0	25,0	38,0	38,0	38,0	38,0	38,0	38,0

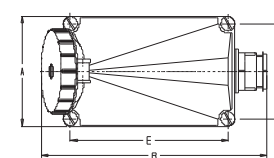
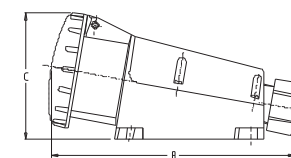
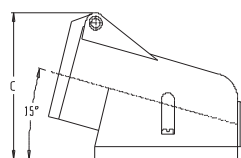
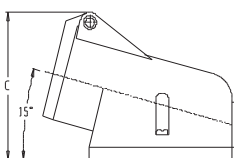
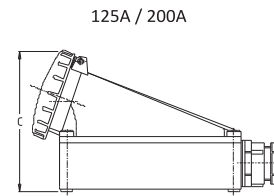
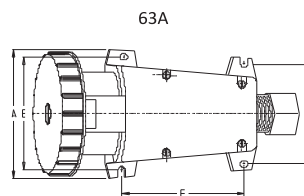
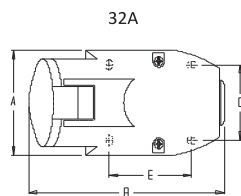
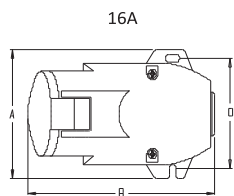

# Linha: Plugues e Tomadas Blindadas Brasikon

## Dimensões e Desenhos Técnicos

### Tomada de Embutir e Tomada de Embutir Negativa (macho) 16A até 200A

Corrente	16A				32A				63A			125A			200A		
	Pólos	3	4	5	7	3	4	5	7	3	4	5	3	4	5	3	4
A	72,9	85,0	87,5	80,0	85,0	85,0	86,0	80,0	111,0	111,0	111,0	111,4	111,4	111,4	111,4	111,4	111,4
B	62,0	84,0	84,0	80,0	84,0	84,0	85,0	80,0	111,0	111,0	111,0	112,5	112,5	112,5	112,5	112,5	112,5
C	67,5	68,3	83,0	84,5	68,3	68,3	82,8	95,5	123,5	123,5	123,5	148,6	148,6	148,6	148,6	148,6	148,6
D	46,5	70,0	70,0	60,0	69,0	69,0	70,0	60,0	89,0	89,0	89,0	88,0	88,0	88,0	88,0	88,0	88,0
E	46,5	70,0	70,0	60,0	69,0	69,0	70,0	60,0	89,0	89,0	89,0	88,0	88,0	88,0	88,0	88,0	88,0
F	24,8	-	-	-	-	-	35,5	-	-	-	-	45,4	45,4	45,4	45,4	45,4	45,4
ØG	52,0	60,0	67,0	58,0	67,0	67,0	75,0	64,0	92,0	92,0	92,0	95,0	95,0	95,0	95,0	95,0	95,0
ØH	4,5	4,5	5,5	5,5	4,5	4,5	4,5	5,5	4,5	4,0	4,5	4,5	4,5	4,5	4,5	4,5	4,5
RI	3,2	-	-	-	-	-	7,0	-	-	-	-	8,1	8,1	8,1	8,1	8,1	8,1

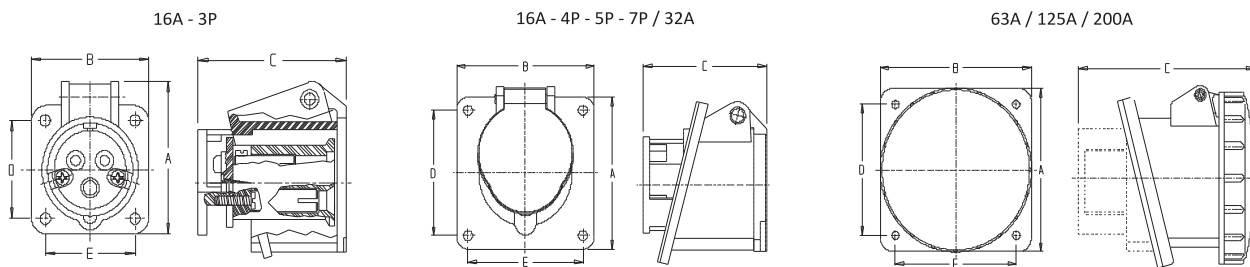

#### Detalhes de Furação de Painel

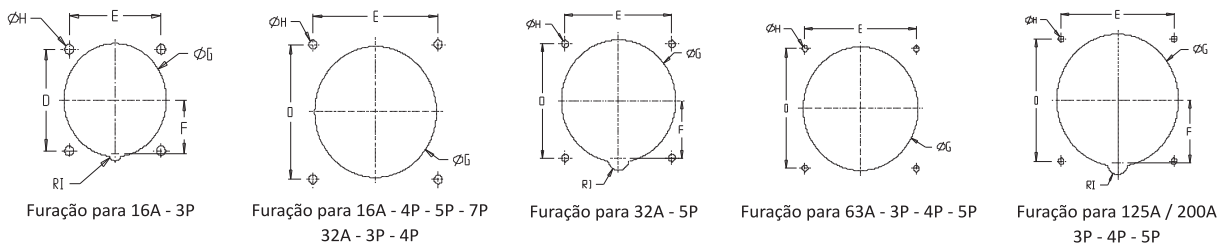

### Acoplamento e Acoplamento Negativo (macho) - 16A até 200A

Corrente	16A				32A				63A			125A			200A		
	Pólos	3	4	5	7	3	4	5	7	3	4	5	3	4	5	3	4
A	50,4	58,2	65,4	64,3	65,4	72,0	72,0	72,0	111,0	111,0	111,0	123,5	123,5	123,5	122,6	122,6	122,6
B	117,7	115,4	143,0	166,0	148,0	148,0	169,0	169,0	263,5	263,5	263,5	329,0	329,0	329,0	342,6	342,6	342,6
C	71,0	78,0	97,5	83,5	87,5	87,5	94,6	94,6	112,5	112,5	112,5	127,0	127,0	127,0	124,8	124,8	124,8
Rosca BSP	-	-	-	-	-	-	-	-	1 1/2"	1 1/2"	1 1/2"	2 1/4"	2 1/4"	2 1/4"	2 1/4"	2 1/4"	2 1/4"
Ø Cabo	Mín.	8,0	8,0	13,0	13,0	15,0	15,0	13,0	13,0	32,0	32,0	37,0	37,0	37,0	37,0	37,0	37,0
	Máx.	13,0	13,0	15,0	15,0	22,0	22,0	15,0	15,0	38,0	38,0	38,0	44,0	44,0	44,0	44,0	44,0

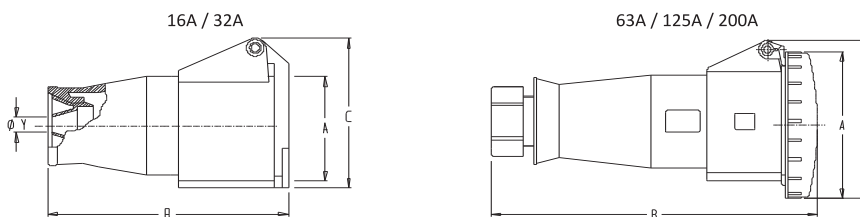



## Linha: Plugues e Tomadas Blindadas Newkon



### Características Gerais

#### Matérias Primas:

Partes plásticas: Poliammida 6.6 auto-extinguível (C.S.A. C22.2 nº6 e UL 94HB-Mil spec 22096).

Vedações e guarnições: Neoprene

Terminais: Latão maciço

#### Temperatura Operação:

0 / 120°C trabalho contínuo.

200°C (30 minutos).

#### Construção:

Conforme normas NBR IEC 60309-1, IEC 60309-2, DIN 49462, DIN 49463, CEE 17-BS4343 e VDE 0623.

#### Tensão máxima de trabalho:

690 Volts RMS - Conforme NBR IEC 60309-1

#### Identificação dos Terminais:

Conforme U.L., CSA e NBR IEC 60309

Fases	Neutro	Terra
1 - 2 - 3		
R - S - T	N	⏚
X - Y - Z	W	
L		

#### Resistência ao Arco:

Conforme C.S.A. C22.2-182-1 (1990)

Altamente isolante (até 750V - 500Hz)

Obs.: Dimensões e Desenhos no final da linha.

#### Rigidez Dielétrica: INBR IEC 60309-1

Tens. Nom.	Tens. Ensaio
Até 50V	500V
Até 415V	2.000V
Até 500V	2.500V
Acima de 500V	3.000V

#### Resistência ao Impacto:

Conforme C.S.A. C22.2 nº 182-1 parágrafos 7.4.2 e 7.4.4

#### Resistência à Abrasão:

Conforme C.S.A. C22.2 nº 182-1 parágrafos 7.4.3 e 7.4.4

#### Estanqueidade:

Conforme norma NBR IEC 60529

#### Proteção Cabos:

Conforme C.S.A. C. nº 182-1 parágrafos 7.3

#### Tipo de Cabos:







Conforme U.L.62 e C.S.A.C22.2 nº 49

#### Resistências à Corrosão: (Partes Plásticas)

Salt Spray, Álcool, Óleo, Solventes, Lubrificantes, Graxas, Meios ácidos, Alcalinas e Outros Agentes Químicos.

Contatos Niquelados crescer NQ após o código

## Linha: Plugues e Tomadas Blindadas Newkon

Produto		Amp.	Pólos	24V	110 / 130V	220 / 240V	380 / 440V	600V	Até 500Hz
<b>Plugue</b> 	IP 44 ▲	16	3	N-3072	N-3074	N-3076	N-3079	N-3075	N-3070
	Prensa cabos interno	16	4	N-4072	N-4074	N-4079	N-4076	N-4075	N-4070
	Ligação nos contatos (mm <sup>2</sup> )	16	5	N-5072	N-5074	N-5079	N-5076	N-5075	N-5070
	<b>Amp.</b> 16A 32A	32	3	N-3272	N-3274	N-3276	N-3279	N-3275	N-3270
	Mín. 2,5 4,0	32	4	N-4272	N-4274	N-4279	N-4276	N-4275	N-4270
	Máx. 4,0 6,0	32	5	N-5272	N-5274	N-5279	N-5276	N-5275	N-5270
		63	3		N-3574	N-3576	N-3579	N-3575	
		63	4		N-4574	N-4579	N-4576	N-4575	
		63	5		N-5574	N-5579	N-5576	N-5575	
	<b>Tomada de sobrepôr</b> 	IP 44 ▲ - 16/32A	16	3	N-3002	N-3004	N-3006	N-3009	N-3005
IP 67 ▲▲ - 63A		16	4	N-4002	N-4004	N-4009	N-4006	N-4005	N-4000
Opção c/ rosca GAS (*)		16	5	N-5002	N-5004	N-5009	N-5006	N-5005	N-5000
Ligação nos contatos (mm <sup>2</sup> )		32	3	N-3202	N-3204	N-3206	N-3209	N-3205	N-3200
<b>Amp.</b> 16A 32A 63A		32	4	N-4202	N-4204	N-4209	N-4206	N-4205	N-4200
Mín. 2,5 4,0 10,0		32	5	N-5202	N-5204	N-5209	N-5206	N-5205	N-5200
Máx. 4,0 6,0 16,0		63	4		N-4504	N-4509	N-4506	N-4505	
<b>Plugue Fixo de sobrepôr (inlet)</b> 	IP 44 ▲	16	3	NN-3002	NN-3004	NN-3006	NN-3009	NN-3005	NN-3000
	Opção c/ rosca GAS (*)	16	4	NN-4002	NN-4004	NN-4009	NN-4006	NN-4005	NN-4000
		16	5	NN-5002	NN-5004	NN-5009	NN-5006	NN-5005	NN-5000
	Ligação nos contatos (mm <sup>2</sup> )	32	3	NN-3202	NN-3204	NN-3206	NN-3209	NN-3205	NN-3200
	<b>Amp.</b> 16A 32A	32	4	NN-4202	NN-4204	NN-4209	NN-4206	NN-4205	NN-4200
	Mín. 2,5 4,0	32	5	NN-5202	NN-5204	NN-5209	NN-5206	NN-5205	NN-5200
	Máx. 4,0 6,0								
<b>Tomada de embutir</b> 	IP 44 ▲	16	3	N-3042	N-3044	N-3046	N-3049	N-3045	N-3040
		16	4	N-4042	N-4044	N-4049	N-4046	N-4045	N-4040
	Ligação nos contatos (mm <sup>2</sup> )	16	5	N-5042	N-5044	N-5049	N-5046	N-5045	N-5040
	<b>Amp.</b> 16A 32A	32	3	N-3242	N-3244	N-3246	N-3249	N-3245	N-3240
	Mín. 2,5 4,0	32	4	N-4242	N-4244	N-4249	N-4246	N-4245	N-4240
	Máx. 4,0 6,0	32	5	N-5242	N-5244	N-5249	N-5246	N-5245	N-5240
<b>Plugue Fixo de embutir (inlet)</b> 	IP 44 ▲	16	3	NN-3042	NN-3044	NN-3046	NN-3049	NN-3045	NN-3040
		16	4	NN-4042	NN-4044	NN-4049	NN-4046	NN-4045	NN-4040
	Ligação nos contatos (mm <sup>2</sup> )	16	5	NN-5042	NN-5044	NN-5049	NN-5046	NN-5045	NN-5040
	<b>Amp.</b> 16A 32A	32	3	NN-3242	NN-3244	NN-3246	NN-3249	NN-3245	NN-3240
	Mín. 2,5 4,0	32	4	NN-4242	NN-4244	NN-4249	NN-4246	NN-4245	NN-4240
	Máx. 4,0 6,0	32	5	NN-5242	NN-5244	NN-5249	NN-5246	NN-5245	NN-5240
	Uso exclusivo c/ acoplamento Brasikon								
<b>Tomada de embutir</b> 	IP 67 ▲▲	63	4		N-4544	N-4549	N-4546	N-4545	
	Ligação nos contatos (mm <sup>2</sup> )								
	<b>Amp.</b> 63A								
	Mín. 10,0 Máx. 16,0								
<b>Acoplamento</b> 	IP 44 ▲	16	3	N-3052	N-3054	N-3056	N-3059	N-3055	
		16	4	N-4052	N-4054	N-4059	N-4056	N-4055	
	Ligação nos contatos (mm <sup>2</sup> )	32	3	N-3252	N-3254	N-3256	N-3259	N-3255	
	<b>Amp.</b> 16A 32A	32	4	N-4252	N-4254	N-4259	N-4256	N-4255	
	Mín. 2,5 4,0								
	Máx. 4,0 6,0								

Para Contatos Niquelados acrescentar NQ após o código

(\*) para rosca Gas verificar adaptadores página 97

# Linha: Plugues e Tomadas Blindadas Newkon

## Dimensões e Desenhos Técnicos

### Plugues Newkon 16A até 63A

Corrente	16A			32A			63A			
	Pólos	3	4	5	3	4	5	3	4	5
A		43,5	49,2	57,0	57,0	57,0	63,0	69,0	69,0	69,0
B		127,8	127,8	154,9	154,9	154,9	171,6	244,4	244,4	244,4
C		53,1	60,6	71,5	71,5	71,5	77,8	110,3	110,3	110,3
Rosca BSP		-	-	-	-	-	-	1 1/2"	1 1/2"	1 1/2"
Ø Cabo	Min.	8,0	8,0	13,0	15,0	15,0	13,0	32,0	32,0	32,0
	Máx.	13,0	13,0	15,0	22,0	22,0	15,0	38,0	38,0	38,0

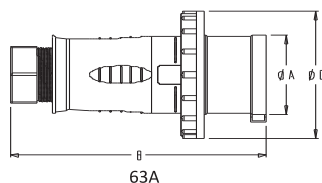
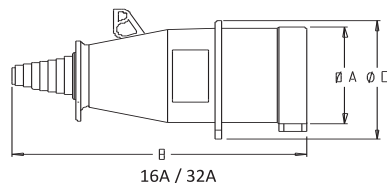

### Plugues fixo de Embutir Newkon 16A até 32A

Corrente	16A			32A			
	Pólos	3	4	5	3	4	5
A		88,6	88,6	88,6	88,6	88,6	88,6
B		71,2	71,2	71,2	71,2	71,2	71,2
C		85,0	85,0	85,0	85,0	85,0	85,0
D		71,5	71,5	71,5	71,5	71,5	71,5
E		56,0	56,0	56,0	56,0	56,0	56,0
F		35,7	35,7	35,7	35,7	35,7	35,7
ØG		48,5	48,5	62,0	62,0	62,0	68,0
ØH		4,5	4,5	4,5	4,5	4,5	4,5

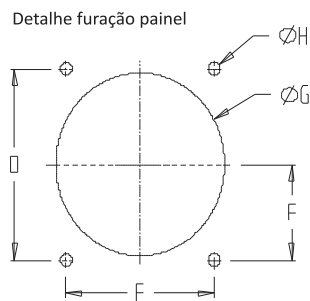
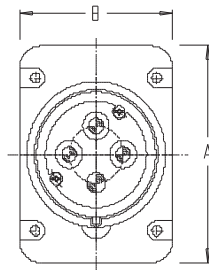
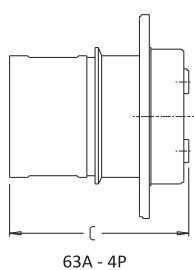

### Tomadas de Sobrepor Newkon 16A até 63A

Corrente	16A			32A			63A
	Pólos	3	4	5	3	4	5
A		73,0	73,0	73,0	73,0	73,0	94,0
B		123,0	123,0	123,0	123,0	123,0	193,0
C		102,0	102,0	102,0	102,0	102,0	135,0
D		61,0	61,0	61,0	61,0	61,0	119,0
E		109,0	109,0	109,0	109,0	109,0	169,5
Rosca BSP		16	16	21	21,0	21,0	29
Ø Cabo	Min.	10,0	10,0	10,0	13,0	13,0	13,0
	Máx.	14,0	14,0	14,0	18,0	18,0	18,0

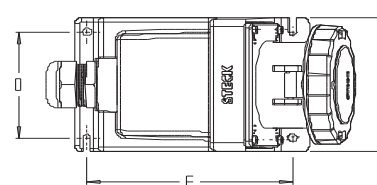
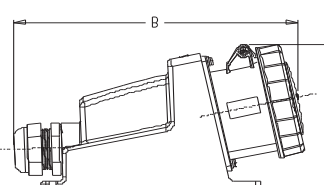
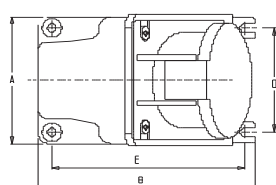
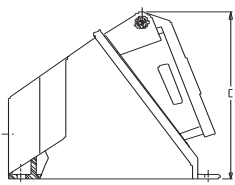

# Linha: Plugues e Tomadas Blindadas Newkon

## Dimensões e Desenhos Técnicos

### Tomada de Embutir Newkon 16A até 63A

Corrente	16A			32A			63A
Pólos	3	4	5	3	4	5	4
A	87,0	87,0	87,0	87,0	87,0	87,0	110,0
B	70,0	70,0	70,0	70,0	70,0	70,0	110,0
C	71,5	71,5	71,5	71,5	71,5	86,4	187,0
D	70,0	70,0	70,0	70,0	70,0	70,0	98,0
E	55,0	55,0	55,0	55,0	55,0	55,0	98,0
F	-	-	32,0	32,0	32,0	33,3	36,5
ØG	62,0	62,0	64,0	64,0	64,0	74,0	80,0
ØH	4,5	4,5	4,5	4,5	4,5	4,5	4,5
RI	-	-	7,0	7,0	7,0	7,0	8,5

16A - 3P - 4P + 5P / 32A - 3P - 4P

32A - 5P

63A - 4P

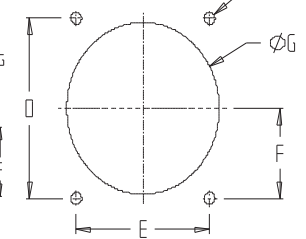
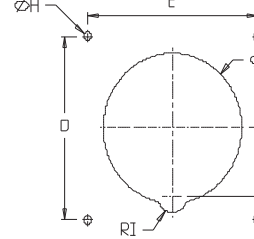
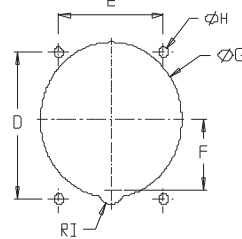
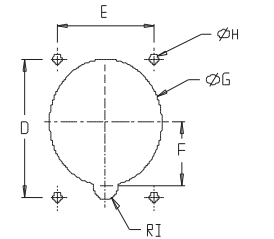
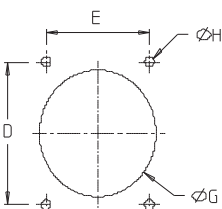
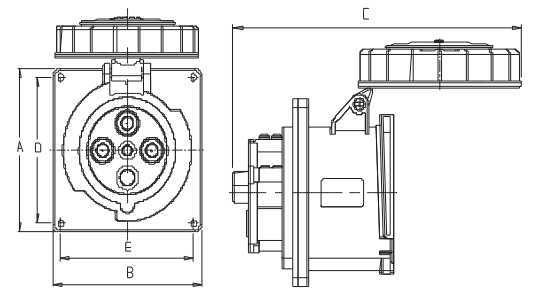
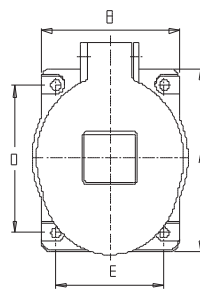
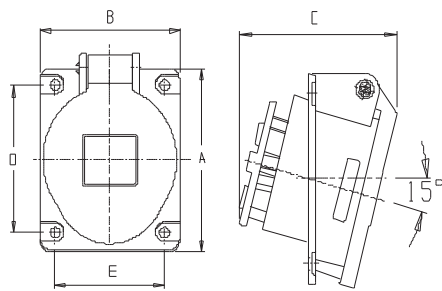

Furação para 16A 3P - 4P

Furação para 16A 5P/32A - 3P - 4P

Furação para 32A 5P

Furação para 63A 4P

Furação Painel

### Acoplamentos Newkon

Corrente	16A			32A		
Pólos	3	4	5	3	4	5
A	49,6	56,0	62,9	64,4	64,4	70,4
B	135,0	135,0	158,0	158,0	158,0	163,0
C	69,6	79,0	82,5	87,7	87,7	94,6
Ø Cabo	Min.	8,0	8,0	13,0	15,0	15,0
	Máx.	13,0	13,0	15,0	22,0	22,0

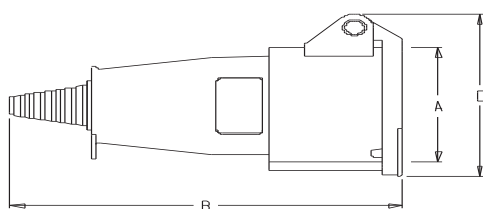

16A / 32A

## Linha: Plugues e Tomadas Blindadas à Prova D'água Shock Tite®

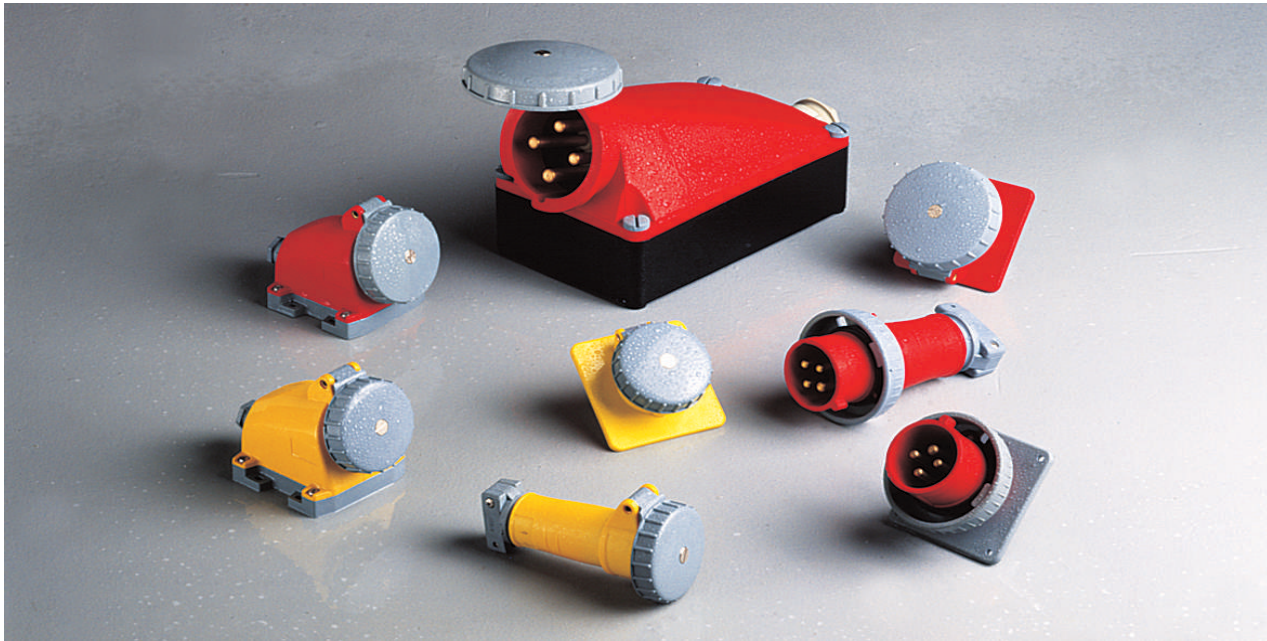

### Características Gerais

Obs.: Dimensões e Desenhos no final da linha.

#### Matérias Primas:

Carcça, Alojamento, Prensa cabos e Aliviador de Tensão: Termo-plástico auto-extinguível (C.S.A. C.22.2 nº 6 e U.L. 94 HB-Mil spec 22096).  
Tampa Trava-Subtampa e Arruela Trava: Poliamida 6.6.  
Vedações e Guarnições: SBR (Neoprene sob consulta).  
Terminais: Latão maciço.

#### Temperatura Operação:

0 / 120°C trabalho contínuo.  
200°C (30 minutos).

#### Construção:

Conforme normas NBR IEC 60309-1, IEC 60309-2, DIN 49462, DIN 49463, CEE 17-BS4343 e VDE 0623 CE 127-12, NFC 63310 SEMKO 117.

#### Tensão máxima de trabalho:

690 Volts RMS - Conforme NBR IEC 60309-1

#### Identificação dos Terminais:

Conforme U.L., CSA e NBR IEC 60309

Fases	Neutro	Terra
1 - 2 - 3 R - S - T X - Y - Z L	N W	

#### Resistência ao Arco:

Conforme C.S.A. C22.2-182-1 (1990)  
Altamente isolante (até 750V - 500Hz)

Rigidez Dielétrica: NBR IEC 60309-1

Tens. Nom.	Tens. Ensaio
Até 50V	500V
Até 415V	2.000V
Até 500V	2.500V
Acima de 500V	3.000V

#### Resistência ao Impacto:

Conforme C.S.A. C22.2 nº 182-1 parágrafos 7.4.2 e 7.4.4

#### Resistência à Abrasão:

Conforme C.S.A. C22.2 nº 182-1 parágrafos 7.4.3 e 7.4.4

#### Estanqueidade:

À prova d'água conforme C.S.A C22.2 - especificação 943 NBR IEC 60309-1 - 18(d)

#### Proteção Cabos:

Conforme C.S.A. C. nº 182-1 parágrafos 7.3

#### Tipo de Cabos:

Conforme U.L.62 e C.S.A.C22.2 nº 49

#### Resistências à Corrosão: (Partes Plásticas)

Salt Spray, Álcool, Óleo, Solventes, Lubrificantes, Graxas, Meios ácidos, Alcalinas e Outros Agentes Químicos.

#### Contatos Niquelados :





Acrescer NQ após o código

# Linha: Plugues e Tomadas Blindadas à Prova D'água Shock Tite®

Produto	Amp.	Pólos	24V	110 / 130V	220 / 240V	380 / 440V	600V	Até 500Hz																					
<b>Plugue</b>  IP 67 Ligação nos contatos (mm <sup>2</sup> ) <table border="1" data-bbox="219 549 609 636"> <thead> <tr> <th>Amp.</th> <th>16A</th> <th>32A</th> <th>63A</th> <th>125A</th> <th>200A</th> <th>250A</th> </tr> </thead> <tbody> <tr> <td>Mín.</td> <td>2,5</td> <td>4,0</td> <td>10,0</td> <td>35,0</td> <td>-</td> <td>-</td> </tr> <tr> <td>Máx.</td> <td>4,0</td> <td>6,0</td> <td>16,0</td> <td>70,0</td> <td>95,0</td> <td>95,0</td> </tr> </tbody> </table>	Amp.	16A	32A	63A	125A	200A	250A	Mín.	2,5	4,0	10,0	35,0	-	-	Máx.	4,0	6,0	16,0	70,0	95,0	95,0	16	3	S-3072W	S-3074W	S-3076W	S-3079W	S-3075W	S-3070W
	Amp.	16A	32A	63A	125A	200A	250A																						
	Mín.	2,5	4,0	10,0	35,0	-	-																						
	Máx.	4,0	6,0	16,0	70,0	95,0	95,0																						
	16	4	S-4072W	S-4074W	S-4079W	S-4076W	S-4075W	S-4070W																					
	16	5	S-5072W	S-5074W	S-5079W	S-5076W	S-5075W	S-5070W																					
	32	3	S-3272W	S-3274W	S-3276W	S-3279W	S-3275W	S-3270W																					
	32	4	S-4272W	S-4274W	S-4279W	S-4276W	S-4275W	S-4270W																					
	32	5	S-5272W	S-5274W	S-5279W	S-5276W	S-5275W	S-5270W																					
	63	3	S-3572W	S-3574W	S-3576W	S-3579W	S-3575W	S-3570W																					
	63	4	S-4572W	S-4574W	S-4579W	S-4576W	S-4575W	S-4570W																					
	63	5	S-5572W	S-5574W	S-5579W	S-5576W	S-5575W	S-5570W																					
	125	3	S-3672W	S-3674W	S-3676W	S-3679W	S-3675W	S-3670W																					
	125	4	S-4672W	S-4674W	S-4679W	S-4676W	S-4675W	S-4670W																					
	125	5	S-5672W	S-5674W	S-5679W	S-5676W	S-5675W	S-5670W																					
	200	3	S-3872W	S-3874W	S-3876W	S-3879W	S-3875W	S-3870W																					
	200	4	S-4872W	S-4874W	S-4879W	S-4876W	S-4875W	S-4870W																					
	200	5		S-5874W	S-5879W	S-5876W	S-5875W																						
	250	4						S-4971/W																					
	<b>Tomada de sobrepôr</b>  IP 67 Opção c/ rosca GAS (*) Ligação nos contatos (mm <sup>2</sup> ) <table border="1" data-bbox="389 937 552 1024"> <thead> <tr> <th>Amp.</th> <th>16A</th> <th>32A</th> </tr> </thead> <tbody> <tr> <td>Mín.</td> <td>2,5</td> <td>4,0</td> </tr> <tr> <td>Máx.</td> <td>4,0</td> <td>6,0</td> </tr> </tbody> </table>	Amp.	16A	32A	Mín.	2,5	4,0	Máx.	4,0	6,0	16	3	S-3002W	S-3004W	S-3006W	S-3009W	S-3005W	S-3000W											
Amp.		16A	32A																										
Mín.		2,5	4,0																										
Máx.		4,0	6,0																										
16		4	S-4002W	S-4004W	S-4009W	S-4006W	S-4005W	S-4000W																					
16		5	S-5002W	S-5004W	S-5009W	S-5006W	S-5005W	S-5000W																					
32		3	S-3202W	S-3204W	S-3206W	S-3209W	S-3205W	S-3200W																					
32	4	S-4202W	S-4204W	S-4209W	S-4206W	S-4205W	S-4200W																						
32	5	S-5202W	S-5204W	S-5209W	S-5206W	S-5205W	S-5200W																						
<b>Tomada de sobrepôr</b>  IP 67 Opção c/ rosca GAS (*) Ligação nos contatos (mm <sup>2</sup> ) <table border="1" data-bbox="389 1153 495 1239"> <thead> <tr> <th>Amp.</th> <th>63A</th> </tr> </thead> <tbody> <tr> <td>Mín.</td> <td>10,0</td> </tr> <tr> <td>Máx.</td> <td>16,0</td> </tr> </tbody> </table>	Amp.	63A	Mín.	10,0	Máx.	16,0	63	3	S-3502W	S-3504W	S-3506W	S-3509W	S-3505W	S-3500W															
	Amp.	63A																											
	Mín.	10,0																											
	Máx.	16,0																											
63	4	S-4502W	S-4504W	S-4509W	S-4506W	S-4505W	S-4500W																						
63	5	S-5502W	S-5504W	S-5509W	S-5506W	S-5505W	S-5500W																						
<b>Tomada de sobrepôr</b>  IP 67 Opção c/ rosca GAS (*) Ligação nos contatos (mm <sup>2</sup> ) <table border="1" data-bbox="389 1390 609 1476"> <thead> <tr> <th>Amp.</th> <th>125A</th> <th>200A</th> <th>250A</th> </tr> </thead> <tbody> <tr> <td>Mín.</td> <td>35,0</td> <td>-</td> <td>-</td> </tr> <tr> <td>Máx.</td> <td>70,0</td> <td>95,0</td> <td>95,0</td> </tr> </tbody> </table>	Amp.	125A	200A	250A	Mín.	35,0	-	-	Máx.	70,0	95,0	95,0	125	3	S-3602W	S-3604W	S-3606W	S-3609W	S-3605W	S-3600W									
	Amp.	125A	200A	250A																									
	Mín.	35,0	-	-																									
	Máx.	70,0	95,0	95,0																									
	125	4	S-4602W	S-4604W	S-4609W	S-4606W	S-4605W	S-4600W																					
	125	5	S-5602W	S-5604W	S-5609W	S-5606W	S-5605W	S-5600W																					
200	5		S-5804W	S-5809W	S-5806W	S-5805W																							
250	4						S-4901/W																						
<b>Tomada de embutir</b>  IP 67 Ligação nos contatos (mm <sup>2</sup> ) <table border="1" data-bbox="235 1746 617 1832"> <thead> <tr> <th>Amp.</th> <th>16A</th> <th>32A</th> <th>63A</th> <th>125A</th> <th>200A</th> <th>250A</th> </tr> </thead> <tbody> <tr> <td>Mín.</td> <td>2,5</td> <td>4,0</td> <td>10,0</td> <td>35,0</td> <td>-</td> <td>-</td> </tr> <tr> <td>Máx.</td> <td>4,0</td> <td>6,0</td> <td>16,0</td> <td>70,0</td> <td>95,0</td> <td>95,0</td> </tr> </tbody> </table>	Amp.	16A	32A	63A	125A	200A	250A	Mín.	2,5	4,0	10,0	35,0	-	-	Máx.	4,0	6,0	16,0	70,0	95,0	95,0	16	3	S-3042W	S-3044W	S-3046W	S-3049W	S-3045W	S-3040W
	Amp.	16A	32A	63A	125A	200A	250A																						
	Mín.	2,5	4,0	10,0	35,0	-	-																						
	Máx.	4,0	6,0	16,0	70,0	95,0	95,0																						
	16	4	S-4042W	S-4044W	S-4049W	S-4046W	S-4045W	S-4040W																					
	16	5	S-5042W	S-5044W	S-5049W	S-5046W	S-5045W	S-5040W																					
	32	3	S-3242W	S-3244W	S-3246W	S-3249W	S-3245W	S-3240W																					
	32	4	S-4242W	S-4244W	S-4249W	S-4246W	S-4245W	S-4240W																					
	32	5	S-5242W	S-5244W	S-5249W	S-5246W	S-5245W	S-5240W																					
	63	3	S-3542W	S-3544W	S-3546W	S-3549W	S-3545W	S-3540W																					
	63	4	S-4542W	S-4544W	S-4549W	S-4546W	S-4545W	S-4540W																					
	63	5	S-5542W	S-5544W	S-5549W	S-5546W	S-5545W	S-5540W																					
	125	3	S-3642W	S-3644W	S-3646W	S-3649W	S-3645W	S-3640W																					
	125	4	S-4642W	S-4644W	S-4649W	S-4646W	S-4645W	S-4640W																					
125	5	S-5642W	S-5644W	S-5649W	S-5646W	S-5645W	S-5640W																						
200	5		S-5844/W	S-5849/W	S-5846/W	S-5845/W																							
250	4						S-4941/W																						

Para Contatos Niquelados acrescentar NQ após o código  
 (\*) para rosca Gas verificar adaptadores página 67

## Linha: Plugues e Tomadas Blindadas à Prova D'água Shock Tite®

Produto	Amp.	Pólos	24V	110 / 130V	220 / 240V	380 / 440V	600V	Até 500Hz																					
<b>Plugue Fixo de embutir (inlet) IP67</b>  <p>Ligação nos contatos (mm<sup>2</sup>)</p> <table border="1"> <thead> <tr> <th>Amp.</th> <th>16A</th> <th>32A</th> <th>63A</th> <th>125A</th> <th>200A</th> <th>250A</th> </tr> </thead> <tbody> <tr> <td>Mín.</td> <td>2,5</td> <td>4,0</td> <td>10,0</td> <td>35,0</td> <td>-</td> <td>-</td> </tr> <tr> <td>Máx.</td> <td>4,0</td> <td>6,0</td> <td>16,0</td> <td>70,0</td> <td>95,0</td> <td>95,0</td> </tr> </tbody> </table> <p>Uso exclusivo c/ acoplamento Shock Tite</p>	Amp.	16A	32A	63A	125A	200A	250A	Mín.	2,5	4,0	10,0	35,0	-	-	Máx.	4,0	6,0	16,0	70,0	95,0	95,0	16	3	S-3032W	S-3034W	S-3036W	S-3039W	S-3035W	S-3030W
	Amp.	16A	32A	63A	125A	200A	250A																						
	Mín.	2,5	4,0	10,0	35,0	-	-																						
	Máx.	4,0	6,0	16,0	70,0	95,0	95,0																						
	16	4	S-4032W	S-4034W	S-4039W	S-4036W	S-4035W	S-4030W																					
	16	5	S-5032W	S-5034W	S-5039W	S-5036W	S-5035W	S-5030W																					
	32	3	S-3232W	S-3234W	S-3236W	S-3239W	S-3235W	S-3230W																					
	32	4	S-4232W	S-4234W	S-4239W	S-4236W	S-4235W	S-4230W																					
	32	5	S-5232W	S-5234W	S-5239W	S-5236W	S-5235W	S-5230W																					
	63	3	S-3532W	S-3534W	S-3536W	S-3539W	S-3535W	S-3530W																					
	63	4	S-4532W	S-4534W	S-4539W	S-4536W	S-4535W	S-4530W																					
	63	5	S-5532W	S-5534W	S-5539W	S-5536W	S-5535W	S-5530W																					
	125	3	S-3632W	S-3634W	S-3636W	S-3639W	S-3635W	S-3630W																					
	125	4	S-4632W	S-4634W	S-4639W	S-4636W	S-4635W	S-4630W																					
	125	5	S-5632W	S-5634W	S-5639W	S-5636W	S-5635W	S-5630W																					
	200	3	S-3832W	S-3834W	S-3836W	S-3839W	S-3835W	S-3830W																					
	200	4	S-4832W	S-4834W	S-4839W	S-4836W	S-4835W	S-4830W																					
	200	5		S-5834W	S-5839W	S-5836W	S-5835W																						
250	4					S-4931W																							
<b>Acoplamento (extensão) IP67</b>  <p>Ligação nos contatos (mm<sup>2</sup>)</p> <table border="1"> <thead> <tr> <th>Amp.</th> <th>16A</th> <th>32A</th> <th>63A</th> <th>125A</th> <th>200A</th> <th>250A</th> </tr> </thead> <tbody> <tr> <td>Mín.</td> <td>2,5</td> <td>4,0</td> <td>10,0</td> <td>35,0</td> <td>-</td> <td>-</td> </tr> <tr> <td>Máx.</td> <td>4,0</td> <td>6,0</td> <td>16,0</td> <td>70,0</td> <td>95,0</td> <td>95,0</td> </tr> </tbody> </table>	Amp.	16A	32A	63A	125A	200A	250A	Mín.	2,5	4,0	10,0	35,0	-	-	Máx.	4,0	6,0	16,0	70,0	95,0	95,0	16	3	S-3052W	S-3054W	S-3056W	S-3059W	S-3055W	S-3050W
	Amp.	16A	32A	63A	125A	200A	250A																						
	Mín.	2,5	4,0	10,0	35,0	-	-																						
	Máx.	4,0	6,0	16,0	70,0	95,0	95,0																						
	16	4	S-4052W	S-4054W	S-4059W	S-4056W	S-4055W	S-4050W																					
	16	5	S-5052W	S-5054W	S-5059W	S-5056W	S-5055W	S-5050W																					
	32	3	S-3252W	S-3254W	S-3256W	S-3259W	S-3255W	S-3250W																					
	32	4	S-4252W	S-4254W	S-4259W	S-4256W	S-4255W	S-4250W																					
	32	5	S-5252W	S-5254W	S-5259W	S-5256W	S-5255W	S-5250W																					
	63	3	S-3552W	S-3554W	S-3556W	S-3559W	S-3555W	S-3550W																					
	63	4	S-4552W	S-4554W	S-4559W	S-4556W	S-4555W	S-4550W																					
	63	5	S-5552W	S-5554W	S-5559W	S-5556W	S-5555W	S-5550W																					
	125	3	S-3652W	S-3654W	S-3656W	S-3659W	S-3655W	S-3650W																					
	125	4	S-4652W	S-4654W	S-4659W	S-4656W	S-4655W	S-4650W																					
	125	5	S-5652W	S-5654W	S-5659W	S-5656W	S-5655W	S-5650W																					
	200	3	S-3852W	S-3854W	S-3856W	S-3859W	S-3855W	S-3850W																					
	200	4	S-4852W	S-4854W	S-4859W	S-4856W	S-4855W	S-4850W																					
	200	5		S-5854W	S-5859W	S-5856W	S-5855W																						
250	4					S-4951W																							
<b>Tampa de Proteção para Plugs À prova d'água</b> 	16	3			S-61330																								
	16	4			S-61340																								
	16	5			S-61350																								
	32	3/4			S-63340																								
	32	5			S-63350																								
	63	3/4/5			S-66350																								
	125	3/4/5																											
	200/250	3/4/5			S-67350																								
<b>Tomada de Embutir - IP 65 com flange 4x4 para cozinha industrial</b> 	Amp.	Pólos	110 / 130V	220 / 240V	380 / 440V																								
	16	3	S-10700075	S-10700050	S-10700055																								
	16	4	S-10700115	S-10700104	S-10700056																								
	16	5	S-10700118	S-10700120	S-10700119																								
	32	3	S-10700110	S-10700109	S-10700057																								
	32	4	S-10700116	S-10700117	S-10700058																								
	32	5	S-10700121	S-10700123	S-10700122																								

Para Contatos Niquelados acrescentar NQ após o código

# Linha: Plugues e Tomadas Blindadas à Prova D'água Shock Tite®

São os únicos Plugues e Tomadas fabricados no Brasil para uso específico em Containers Eletrificados. Seguem as principais normas internacionais, sendo utilizados em todos os portos do mundo.

Características
IP 67 3P+T 32A 380/440V 3H

## Plugues e Tomadas para Containers

Tomada de Sobrepor Bloqueio Mecânico



SS-4203/B  
SS-4203/D (com disjuntor)  
SS-4203/DZ (com diazed)

Tomada de Sobrepor Compacta



SS-4203/TW

Tomada de Embutir Compacta



SS-4243/TW

Plugue



S-4273W

Acoplamento



S-4253W

Tomada de Sobrepor



S-4203W

Tomada de Embutir



S-4243W

Plugue Fixo de Embutir (inlet)



S-4233W

Para Contatos Niquelados acrescentar NQ após o código /Para rosca Gas verificar adaptadores na página 67



# Linha: Plugues e Tomadas Blindadas à Prova D'água Shock Tite®

## Dimensões e Desenhos Técnicos

### Plugue Shock-Tite® 16A até 250A

Corrente	16A			32A			63A			125A			200A			250A		
Pólos	3	4	5	3	4	5	3	4	5	3	4	5	3	4	5	3	4	5
A	43,5	49,5	56,1	57,3	57,3	63,4	69,5	69,5	69,5	81,5	81,5	81,5	81,5	81,5	81,5	81,5	81,5	81,5
B	149,0	149,0	175,0	183,0	183,0	205,0	252,0	252,0	252,0	326,0	326,0	326,0	326,0	326,0	326,0	326,0	326,0	326,0
C	69,0	77,5	89,0	95,0	95,0	102,0	14,0	14,0	14,0	124,0	124,0	124,0	124,0	124,0	124,0	124,0	124,0	124,0
D	45,0	45,0	45,0	52,0	52,0	52,0	72,5	72,5	72,5	86,0	86,0	86,0	86,0	86,0	86,0	86,0	86,0	86,0
Rosca BSP	1"	1"	1 1/4"	1 1/4"	1 1/4"	1 1/2"	1 1/2"	1 1/2"	1 1/2"	2 2/4"	2 2/4"	2 2/4"	2 2/4"	2 2/4"	2 2/4"	2 2/4"	2 2/4"	2 2/4"
Ø Cabo	Min.	18,0	18,0	22,0	22,0	22,0	32,0	32,0	32,0	37,0	37,0	37,0	37,0	37,0	37,0	37,0	37,0	37,0
	Máx.	25,0	25,0	32,0	32,0	32,0	38,0	38,0	38,0	44,0	44,0	44,0	44,0	44,0	44,0	44,0	44,0	44,0

16A / 32A / 63A / 125A / 200A / 250A

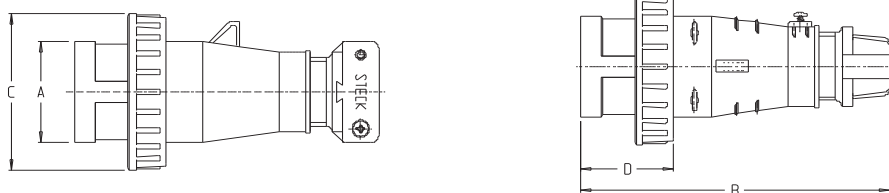

### Plugue fixo de embutir Shock-Tite® 16A até 250A

Corrente	16A			32A			63A			125A			200A			250A		
Pólos	3	4	5	3	4	5	3	4	5	3	4	5	3	4	5	3	4	5
A	95,2	95,2	95,2	95,2	95,2	95,2	114,6	114,6	114,6	139,7	139,7	139,7	139,7	139,7	139,7	139,7	139,7	139,7
B	95,2	95,2	95,2	95,2	95,2	95,2	114,6	114,6	114,6	139,7	139,7	139,7	139,7	139,7	139,7	139,7	139,7	139,7
C	84,5	84,5	99,5	100,5	100,5	103,5	135,5	135,5	135,5	158,2	158,2	158,2	158,2	158,2	158,2	158,2	158,2	158,2
D	79,4	79,4	79,4	79,4	79,4	79,4	98,4	98,4	98,4	123,8	123,8	123,8	123,8	123,8	123,8	123,8	123,8	123,8
E	79,4	79,4	79,4	79,4	79,4	79,4	98,4	98,4	98,4	123,8	123,8	123,8	123,8	123,8	123,8	123,8	123,8	123,8
ØG	49,5	49,5	61,5	63,0	63,0	63,0	76,0	76,0	76,0	88,0	88,0	88,0	88,0	88,0	88,0	88,0	88,0	88,0
ØH	4,5	4,5	4,5	4,5	4,5	4,5	4,5	4,5	4,5	4,5	4,5	4,5	4,5	4,5	4,5	4,5	4,5	4,5

16A / 32A / 63A / 125A / 200A / 250A

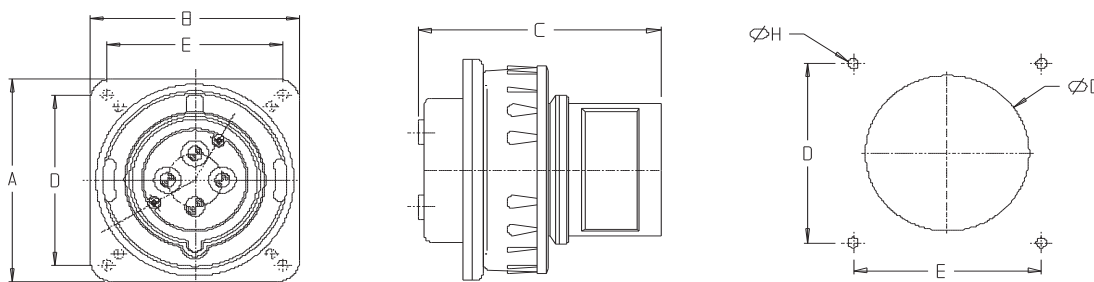

# Linha: Plugues e Tomadas Blindadas à Prova D'água Shock Tite®

## Dimensões e Desenhos Técnicos

### Tomada de Sobrepor Shock-Tite® 16A até 250A

Corrente	16A			32A			63A			125A			200A			250A		
	Pólos 3	4	5	3	4	5	3	4	5	3	4	5	3	4	5	3	4	5
A	91,0	91,0	91,0	102,0	102,0	102,0	121,0	121,0	121,0	160,0	160,0	160,0	160,0	160,0	160,0	160,0	160,0	160,0
B	143,0	143,0	143,0	180,0	180,0	180,0	252,0	252,0	252,0	344,0	344,0	344,0	344,0	344,0	344,0	344,0	344,0	344,0
C	108,0	108,0	108,0	131,0	131,0	131,0	125,0	125,0	125,0	192,0	192,0	192,0	192,0	192,0	192,0	192,0	192,0	192,0
D	79,0	79,0	79,0	90,0	90,0	90,0	85,0	85,0	85,0	139,0	139,0	139,0	139,0	139,0	139,0	139,0	139,0	139,0
E	42,0	42,0	42,0	68,0	68,0	68,0	105,0	105,0	105,0	240,0	240,0	240,0	240,0	240,0	240,0	240,0	240,0	240,0
F	-	-	-	-	-	-	122,0	122,0	122,0	-	-	-	-	-	-	-	-	-
Rosca PG	16	16	16	21,0	21,0	21,0	29	29	29	-	-	-	-	-	-	-	-	-
Rosca BSP	-	-	-	-	-	-	-	-	-	1 1/2"	1 1/2"	1 1/2"	1 1/2"	1 1/2"	1 1/2"	1 1/2"	1 1/2"	1 1/2"
Ø Cabo	Min.	10	10	10	13,0	13,0	13,0	18,0	18,0	18,0	32,0	32,0	32,0	32,0	32,0	32,0	32,0	32,0
	Máx.	14,0	14,0	14,0	18,0	18,0	18,0	13,0	13,0	13,0	38,0	38,0	38,0	38,0	38,0	38,0	38,0	38,0

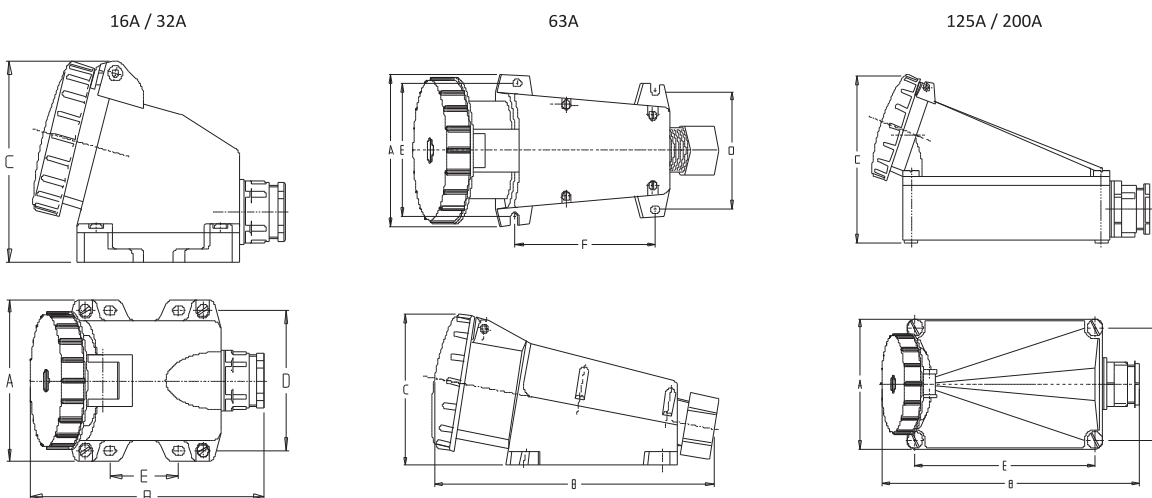

### Acoplamento Shock-Tite® 16A até 250A

Corrente	16A			32A			63A			125A			200A			250A		
	Pólos 3	4	5	3	4	5	3	4	5	3	4	5	3	4	5	3	4	5
A	74,3	82,3	91,0	95,2	95,2	104,0	112,0	112,0	112,0	112,0	112,0	112,0	112,0	112,0	112,0	112,0	112,0	112,0
B	160,0	160,0	183,0	193,0	193,0	215,0	270,0	270,0	270,0	270,0	270,0	270,0	270,0	270,0	270,0	270,0	270,0	270,0
C	78,9	89,2	98,7	99,6	99,6	110,5	114,5	114,5	114,5	114,5	114,5	114,5	114,5	114,5	114,5	114,5	114,5	114,5
Rosca BSP	1"	1"	1 1/4"	1 1/4"	1 1/4"	1 1/2"	1 1/2"	1 1/2"	1 1/2"	1 1/2"	1 1/2"	1 1/2"	1 1/2"	1 1/2"	1 1/2"	1 1/2"	1 1/2"	1 1/2"
Ø Cabo	Min.	18,0	18,0	22,0	22,0	22,0	32,0	32,0	32,0	32,0	32,0	32,0	32,0	32,0	32,0	32,0	32,0	32,0
	Máx.	25,0	25,0	32,0	32,0	38,0	38,0	38,0	38,0	38,0	38,0	38,0	38,0	38,0	38,0	38,0	38,0	38,0

